

County: Jefferson Davis
 Permit #: 0-586
 Driller: JAMES WELLS
 Date drilling completed: 11-8-12

State Well Report

Part 1 - Driller's Log

Mississippi Department of Environmental Quality
 Office of Land and Water Resources
 P.O. Box 2309
 Jackson, MS 39225
 (601)961- 5210
 (601)961- 5228 (fax)

For Office Use Only:
 Aquifer: _____
 Well #: H140
 L. S. Elevation: _____
 E-log #: _____

State Law requires that this report be prepared by the license holder responsible for the work and filed with the Department at the above address within 30 days of completion of drilling of the well or borehole.

<p>Information on Well Owner (Landowner if borehole is not for a water well)</p> <p>Owner Name: <u>Mitchell Bass</u> Mailing Address: <u>229 Hwy 48</u> <u>Oak Vale MS 39656</u> City State Zip Code Telephone No. <u>(601) 792-5719</u></p>	<p>Well or Borehole Location</p> <p>Latitude: <u>31° 20' 65"</u> Longitude: <u>089° 54' 48"</u> Method of Lat/Long (circle one): <u>51</u> Conventional Survey, USGS quad, Hand-held GPS, Survey-grade GPS <u>NW 1/4 SE 1/4 Sec 4 Twn 5N Rng 19W</u> Distance Direction Nearest Town <u>10</u> Miles <u>3</u> of <u>Prentiss</u></p>
--	--

Well / Borehole Data

Date drilling started: 11-8-12 Date drilling completed: 11-8-12 Hole depth: 80 Hole diameter: 7 1/2"

Location of the source of any surface water used for drilling: running creek
 Method of dosing and volume of Chlorine used in drilling and development: shock

Logs run (circle all applicable): No log run Electric Gamma Ray Density Sonic Neutron Other: _____
 Name of organization running log(s): _____

Purpose of borehole (check one): Water Well Geotechnical/Geological Investigation _____ Ground Source Heat Pump _____
 Seismic Survey _____ Other (describe) _____

If drilling is not related to water well construction, skip the remainder of this block

Purpose of Well (check one): Home Industrial _____ Public Supply _____ Irrigation _____ Fish Culture _____ Other: _____

If a flowing well, method of flow regulation: Valve _____ Other (describe) _____

Static Water Level: 30 feet above or below (circle one) land surface Date measured: 11-8-12

Method of Measurement (circle one) steel tape electric tape air line other: _____

Well depth: 80 Well grouted to a depth of 10 feet Type of grout (circle one): Neat Cement Bentonite Mix

Casing length: 60 feet Casing diameter: 4 inches Type of casing: PVC

Screen length: 20 feet Screen diameter: 4 inches Type of screen: PVC

Screen slot size: .008 inches Setting depth: From 60 feet to 80 feet

Type of completion (circle all applicable): Gravel packed Underreamed Telescoped Open hole Natural Development
 Other (describe): _____

Top of lap pipe or reduction in casing: _____ feet. *If telescoped or more than one screen, describe on next page*

Form: OLWR-SWR-1A (04/08)

RECEIVED
 JAN 14 2013
 BY: OLWR

The sketch below only required for water wells

If well telescopes, show depths on sketch.

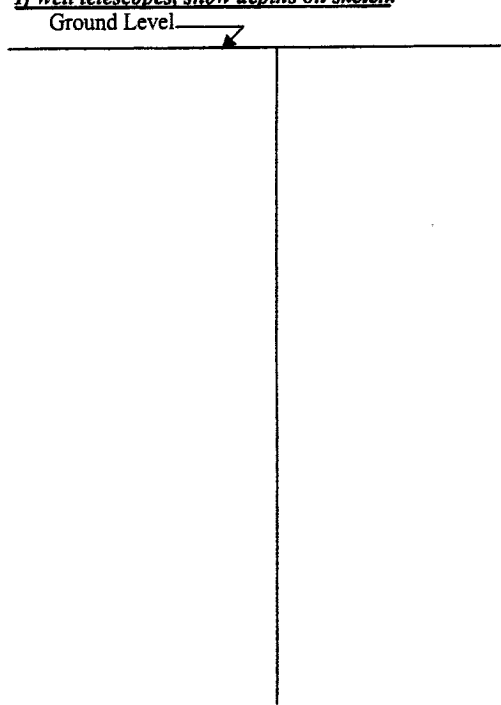

Description of formations encountered must be provided for all wells and boreholes, unless specifically exempted by regulations

Description of Formations Encountered	From (depth)	To (depth)
topsoil	Ground Level	1
clay	1	15
sand	15	20
clay	20	40
sand	40	80

If more than one screen, show location of each on sketch

Sketch the property layout and include the following: 1) the well location; 2) any permanent structures on the property that may aid in locating the well; 3) any roads, power lines, or other items that may aid in locating the property and the well; 4) a north arrow.

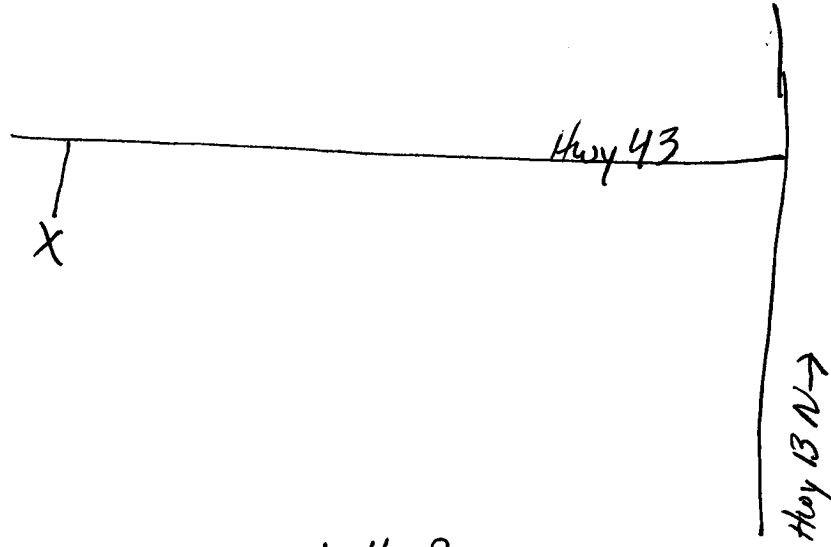

Landowner Name: Mitchell Bass

Form: OLWR-SWR-1A (04/08)

I certify that the well/borehole was drilled, constructed, and completed in accordance with all applicable requirements of the Mississippi Department of Environmental Quality and the Mississippi Department of Health regulations, if applicable, and state laws.

JAMES WELLS 0-586
Print Name of Responsible Licensee and License No. Date

James Wells
Signature of Licensee

RECEIVED
JAN 14 2013
BY: OLWR

STATE WELL REPORT

Part 2

Pump Installer's Completion Report
 Mississippi Department of Environmental Quality
 Office of Land and Water Resources
 P.O. Box 10631
 Jackson, MS 39289-0631
 (601)961-5210
 (601)354-6938 (fax)

For Office Use Only:

Aquifer: _____

Well #: H140

Elevation: _____

County: Jefferson Davis
 Permit #: _____
 Driller: JAMES WELLS
 Date completed: 11-8-12

This report should be prepared by the pump installer in detail and filed with the Department within 30 days of the installation of pump.

Well Owner Information	Well Location
Owner Name: <u>Mitchell Bass</u>	Latitude: <u>31° 20.652</u> Longitude: <u>089° 54.485</u>
Mailing Address: <u>229 Hwy 43</u>	Method of Lat/Long (circle one): <u>25 24</u> Conventional Survey, <u>51</u>
<u>Oakvale MS 39654</u>	USGS quad, Hand-held GPS, Survey-grade GPS
City State Zip Code	<u>NW 1/4 SE 1/4 Sec 4 Twn 5N Rng 19W</u>
Telephone No. <u>(601) 792-5719</u>	Distance Direction Nearest Town
	<u>10</u> Miles <u>S</u> of <u>Prentiss</u>

Pump Type Circle one	Power Type Circle one
Air Lift Jet <u>Submersible</u>	Diesel Engine Gasoline Engine Natural Gas
Bucket Piston Turbine	<u>Electric Motor</u> Hand Tractor PTO
Centrifugal Rotary Flowing Well	Windmill Other (specify): _____
Other (specify): _____	Horse Power Rating of Motor: <u>1</u>
Date Pump Installed: <u>11-8-12</u>	Setting Depth: <u>70</u> feet
Rated Pump Capacity: <u>12</u> Gallons Per Minute	Number of Stages: <u>14</u>

Pump Test Data	Method of Measuring Water Level Circle one
Date Well Tested: <u>11-8-12</u>	Air Line Electric Measuring Line <u>Steel Tape</u>
Static Water Level (A): <u>30</u> Feet Below Land Surface	Other (specify): _____
Pumping Water Level (B): <u>70</u> Feet Below Land Surface	For flowing well, measured shut in head: _____ feet
Drawdown [(B) - (A)]: <u>38 40</u> Feet Below Land Surface	Well yielded <u>17</u> GPM with a drawdown of
Test Pumping Rate: <u>17</u> Gallons Per Minute	<u>5.40</u> feet after <u>4</u> hours of pumping
Duration of Pump Test (minimum 4 hours): <u>4</u> hours	

I HEREBY CERTIFY that the above statements are true to the best of my knowledge.

JAMES WELLS 0-586
 Print Name of Pump Installer and License No. (if applicable)

James Wells
 Signature of Pump Installer

RECEIVED

JAN 14 2013

BY: OLWR